

EPDM Elements

Dimensions

Part#	Coupling Size	D (Inches)	W (Inches)	Wt. (lbs.)
3JE	3	1 7/8	1	0.06
3JES	3	1 7/8	1	0.06
4JE	4	2 5/16	1 1/4	0.10
4JES	4	2 5/16	1 1/4	0.10
5JE	5	2 15/16	1 9/16	0.20
5JES	5	2 15/16	1 9/16	0.20
6JE	6	3 3/4	1 7/8	0.40
6JES	6	3 3/4	1 7/8	0.40
7JE	7	4 11/32	2 3/16	0.62
7JES	7	4 11/32	2 3/16	0.62
8JE	8	5 1/16	2 1/2	1.13
8JES	8	5 1/16	2 1/2	1.13
9JE	9	6	3	1.46
9JES	9	6	3	1.46
10JE	10	7 1/16	3 7/16	2.32
10JES	10	7 1/16	3 7/16	2.32

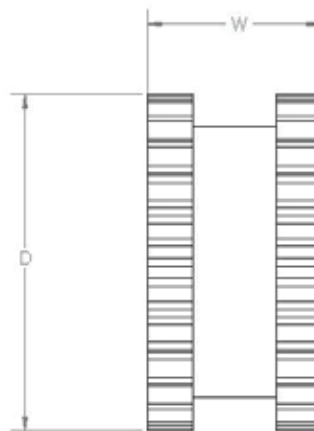

Coupling Ratings & Misalignment

Flange Size	EPDM Sleeves	Max. RPM	HP Per 100 RPM					Torque (in. lbs.)	Stiffness (in. lbs./rad)	E (inches)	Allow. Misalignment (inches)	
			Service Factor								Parallel	Angular
			1.0	1.5	2.0	2.5	3.0					
3	JE, JES	9200	0.1	0.07	0.05	0.04	0.03	60	229	1.188	0.010	0.035
4	JE, JES	7600	0.2	0.13	0.1	0.08	0.07	120	458	1.500	0.010	0.043
5	JE, JES	7600	0.4	0.27	0.2	0.16	0.13	240	916	1.938	0.015	0.056
6	JE, JES	6000	0.7	0.47	0.35	0.28	0.23	450	1718	2.375	0.015	0.070
7	JE, JES	5250	1.2	0.8	0.6	0.48	0.4	725	2769	2.563	0.020	0.081
8	JE, JES	4500	1.8	1.2	0.9	0.72	0.6	1135	4335	2.938	0.020	0.094
9	JE, JES	3750	2.9	1.93	1.45	1.16	0.97	1800	6875	3.500	0.025	0.109
10	JE, JES	3600	4.6	3.07	2.3	1.84	1.53	2875	10980	4.063	0.025	0.128

Neoprene Elements

Dimensions

Part#	Coupling Size	D (Inches)	W (Inches)	Wt. (lbs.)
3JN	3	1 7/8	1	0.06
3JNS	3	1 7/8	1	0.06
4JN	4	2 5/16	1 1/4	0.10
4JNS	4	2 5/16	1 1/4	0.10
5JN	5	2 15/16	1 9/16	0.20
5JNS	5	2 15/16	1 9/16	0.20
6JN	6	3 3/4	1 7/8	0.40
6JNS	6	3 3/4	1 7/8	0.40
7JN	7	4 11/32	2 3/16	0.62
7JNS	7	4 11/32	2 3/16	0.62
8JN	8	5 1/16	2 1/2	1.13
8JNS	8	5 1/16	2 1/2	1.13

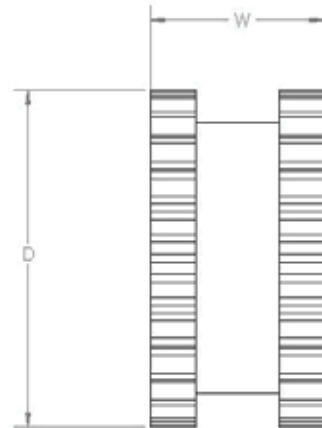

Coupling Ratings & Misalignment

Flange Size	Neoprene Sleeves	Max. RPM	HP Per 100 RPM					Torque (in. lbs.)	Stiffness (in. lbs./rad)	E (inches)	Allow. Misalignment (inches)	
			Service Factor								Parallel	Angular
			1.0	1.5	2.0	2.5	3.0					
3	JN, JNS	9200	0.1	0.07	0.05	0.04	0.03	60	229	1.188	0.010	0.035
4	JN, JNS	7600	0.2	0.13	0.1	0.08	0.07	120	458	1.500	0.010	0.043
5	JN, JNS	7600	0.4	0.27	0.2	0.16	0.13	240	916	1.938	0.015	0.056
6	JN, JNS	6000	0.7	0.47	0.35	0.28	0.23	450	1718	2.375	0.015	0.070
7	JN, JNS	5250	1.2	0.8	0.6	0.48	0.4	725	2769	2.563	0.020	0.081
8	JN, JNS	4500	1.8	1.2	0.9	0.72	0.6	1135	4335	2.938	0.020	0.094

Hytrel Elements

Dimensions

Part#	Coupling Size	D (Inches)	W (Inches)	Wt. (lbs.)
6H	6	3 3/4	1 7/8	0.44
6HS	6	3 3/4	1 7/8	0.44
7H	7	4 11/32	2 3/16	0.69
7HS	7	4 11/32	2 3/16	0.69
8H	8	5 1/16	2 1/2	1.40
8HS	8	5 1/16	2 1/2	1.40
9H	9	6	3	1.80
9HS	9	6	3	1.80
10H	10	7 1/16	3 7/16	2.90
10HS	10	7 1/16	3 7/16	2.90

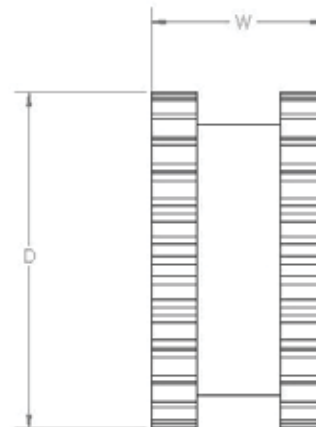

Coupling Ratings & Misalignment

Flange Size	Hytrel Sleeves	Max. RPM	HP Per 100 RPM					Torque (in. lbs.)	Stiffness (in. lbs./rad)	E (inches)	Allow. Misalignment (inches)	
			Service Factor								Parallel	Angular
			1.0	1.5	2.0	2.5	3.0					
6	H, HS	6000	2.90	1.93	1.45	1.16	0.97	1800	10000	2.372	0.010	0.016
7	H, HS	5250	4.60	3.07	2.30	1.84	1.53	2875	20000	2.563	0.012	0.020
8	H, HS	4500	7.20	4.80	3.60	2.88	2.40	4530	30000	2.938	0.015	0.025
9	H, HS	3750	11.40	7.60	5.70	4.56	3.80	7200	47500	3.500	0.017	0.028
10	H, HS	3600	18.00	12.00	9.00	7.20	6.00	11350	100000	4.063	0.020	0.032